

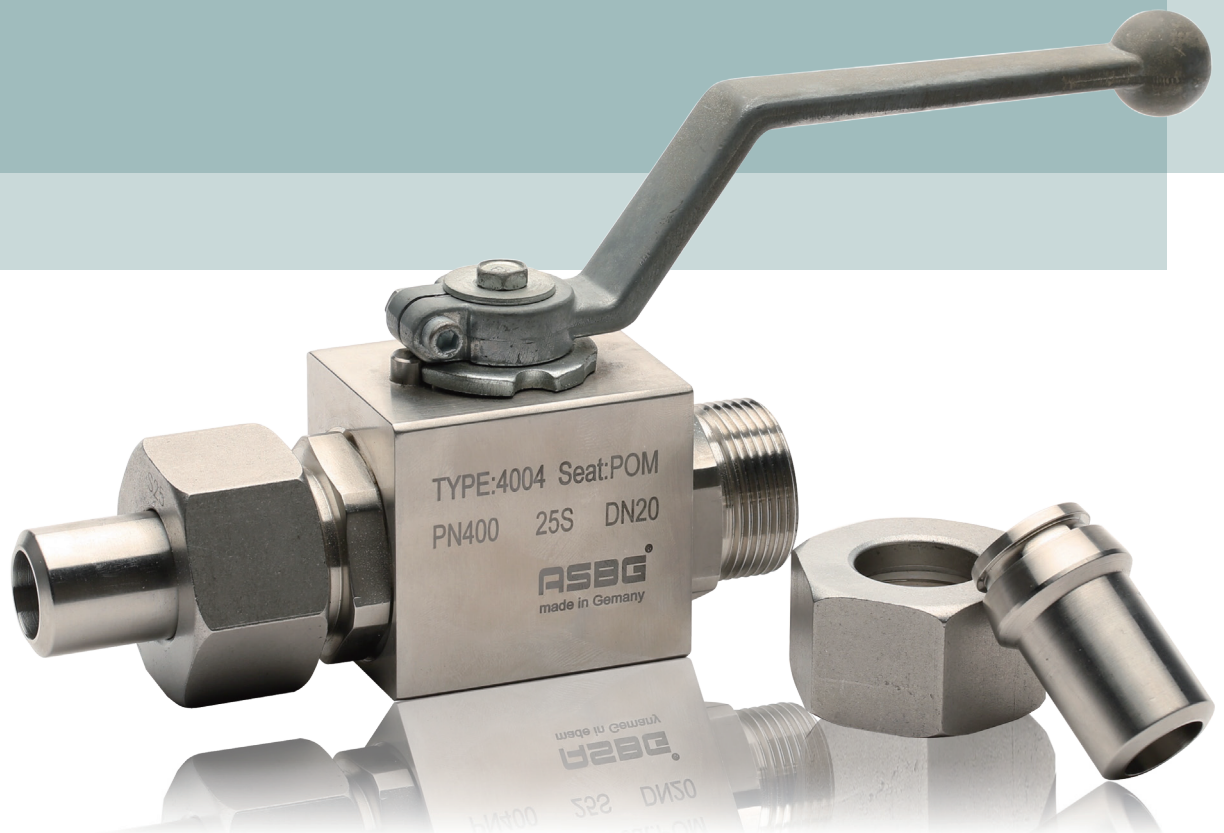

Series A400

HIGH PRESSURE BALL VALVE

A400 series is a three piece body design, the characteristics of three piece design provides convenience for the maintenance and installation. A400 valve is a standard 316 stainless steel, in line with the NACE standard. Every body is cast with a material released number available for query.



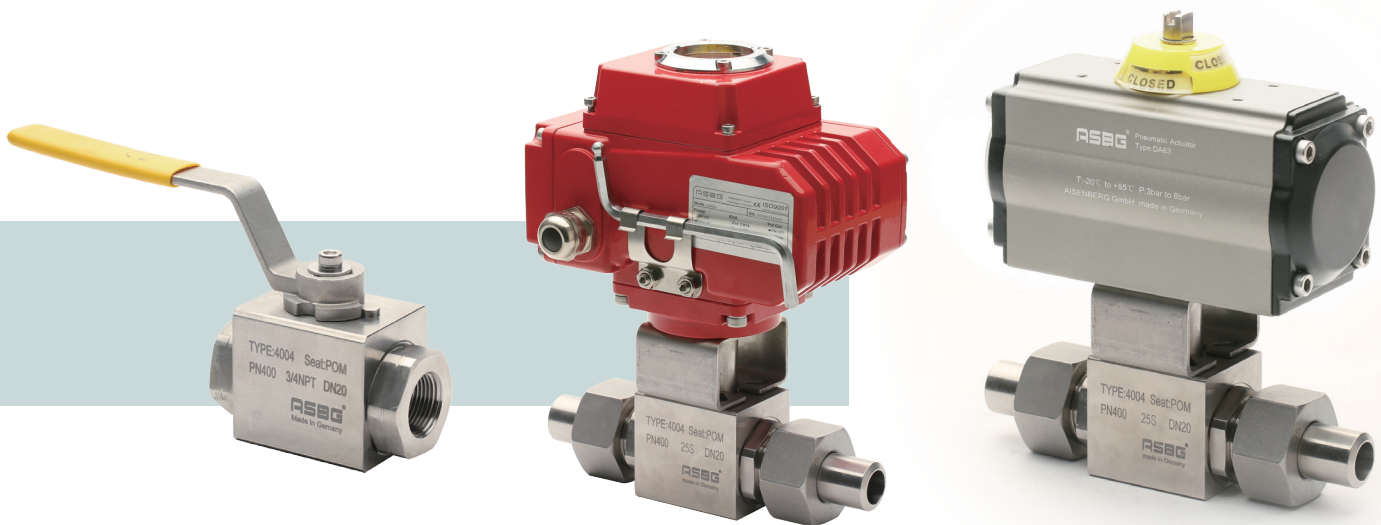

Specification

DESIGN

Body consists of 3 parts, full cylindric bore.

OPERATION

Rotation of the handle through 90°.

Pneumatic aluminum cylinder

The basic type rotary electric control

CONNECTION

Thread 1/8" - 2"

Butt welding 1/8" - 2"

Tube 1/8" - 1-1/4"

FACE TO FACE

Threaded connection DIN

Welded connection DIN

Tube connection DIN

PRESSURE RANGE

PN350

PN400

PN500

NOMINAL PRESSURE

1/8" - 3/8" : 500 Bar

1/8" - 1/2" : 400 Bar

3/4" - 2" : 350 Bar

TEMPERATURE RANGE

-40°C up to +250°C

MATERIALS

Body: 316SS

Ball: 316SS

Ball seal: PTFE

Spindle seal: PTFE

Handle : Stainless steel and Plastic coated

OPTIONS

Electrical position indicator; high handle

The above information is intended for guidance only and the company reserves the right to change any data herein without prior notice!

Model code



1. Product	
A400	High pressure ball valve

2. Control	
A	Manual
B	Pneumatic aluminum cylinder
P	The basic type rotary electric control

3. Type of actuator	
L	Lock lever
U	ISO5211
D	Double acting
S	Single acting normally close
P	Single acting normally open
E	220VAC Electric ON/OFF
F	24VDC Electric ON/OFF
M	380VAC Electric ON/OFF
G	220VAC Electric modulante
H	24VDC Electric modulante
J	380VAC Electric modulante
K	220VAC Explosion-proof electric ON/OFF
N	24VDC Explosion-proof electric ON/OFF
Q	380VAC Explosion-proof electric ON/OFF
R	220VAC Explosion-proof electric modulante
T	24VDC Explosion-proof electric modulante
V	380VAC Explosion-proof electric modulante

4. Body	
2	A105
4	304SS
6	316SS

5. Trim	
4	304SS
6	316SS

6. Seat	
M	POM
K	PEEK

7. Packing	
M	POM
K	PEEK

8. Pressure	
M	PN350
H	PN400
N	PN500

9. Connection	
G	G thread
B	Butt weld
N	NPT thread
K	Tube

10. Caliber			
10	1/8"	15	1"
11	1/4"	16	1 1/4"
12	3/8"	17	1 1/2"
13	1/2"	18	2"
14	3/4"		

1. Stainless steel valve member within the valve body for the same material. Carbon steel valve body is carbon steel, stainless steel trim for 304SS.
2. Stem packing material and sealing material consistent.
3. Takeover of card sets or welding is required to confirm takeover dimensions. Suffix with SS welded pipe for 316SS, with the S suffix welded pipe for 304SS, carbon steel welded pipe, compared with no suffix. Standard pipe dimensions, see "Pipe/Tube selection "

● The above is the standard selection, special requirements, please contact our technical department.

Pipe

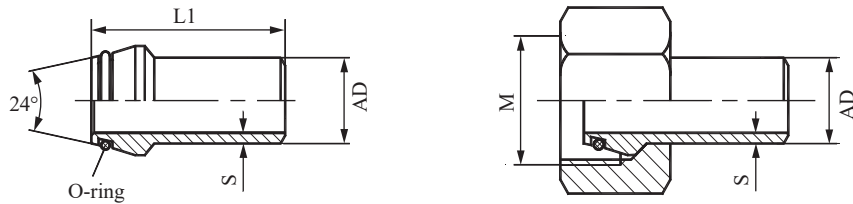

Size	Type	Pipe type	Nut&Pipe type	bar	M	AD	S	L1	O-ring
DN6	8L	SKV08*1.5	SKVM-L08*1.5	400	M14*1.5	8	1.5	30	6*1.5
	10S	SKV10*2.0	SKVM-S10*2.0	500	M18*1.5	10	2	31.5	7.5*1.5
DN8	10L	SKV10*1.5	SKVM-L10*1.5	400	M16*1.5	10	1.5	31.5	7.5*1.5
	12S	SKV12*2.0	SKVM-S12*2.0	500	M20*1.5	12	2	31.5	9*1.5
DN10	12L	SKV12*1.5	SKVM-L12*1.5	400	M18*1.5	12	1.5	31.5	9*1.5
	14S	SKV14*2.0	SKVM-S14*2.0	500	M22*1.5	14	2	37.5	10*2
DN15	15L	SKV15*2.0	SKVM-L15*2.0	400	M22*1.5	15	2	36	12*2
	18L	SKV18*2.5	SKVM-L18*2.5			18	2.5	37	15*2
	16S	SKV16*2.5	SKVM-S16*2.5	400	M24*1.5	16	2.5	37.5	12*2
	20S	SKV20*3.0	SKVM-S20*3.0			20	3	43.5	16.3*2.4
	22L	SKV22*3.0	SKVM-L22*3.0	350	M30*2	22	3	38.5	20*2
DN20	28L	SKV28*4.0	SKVM-L28*4.0	350	M36*2	28	4	41.5	26*2
	25S	SKV25*4.0	SKVM-S25*4.0			25	4	48.5	20.3*2.4
DN25	35L	SKV35*4.0	SKVM-L35*4.0	350	M45*2	35	4	47	32*2.5
	30S	SKV30*4.0	SKVM-S30*4.0	350	M42*2	30	4	51.5	25.3*2.4
DN32	42L	SKV42*5.0	SKVM-L42*4.0	350	M52*2	42	5	47	38*2.5
	38S	SKV38*5.0	SKVM-S38*5.0	350		38	5	55.5	33.3*2.4
DN40	48L	SKV48*5.0	SKVM-L48*5.0	350	M58*2	48	5	47	43*2.5
	50S	SKV50*7.0	SKVM-S50*7.0	350	M68*2	50	7	61	46*3
DN50	60S	SKV60*7.0	SKVM-S60*7.0	350	M76*2	60	7	61	53*3

Tube selection

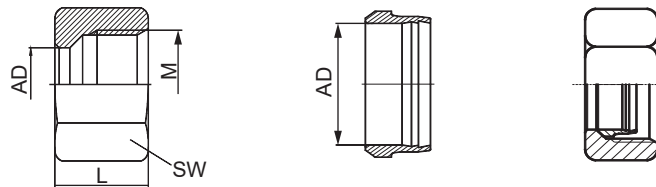

Size	Type	Pipe type	Nut&Pipe type	bar	M	AD	SW	L1
DN6	8L	SR-L08	UMW-L08	400	M14*1.5	8	17	14.5
	10S	SR-S10	UMW-S10	500	M18*1.5	10	22	17.5
DN8	10L	SR-L10	UMW-L10	400	M16*1.5	10	19	15.5
	12S	SR-S12	UMW-S12	500	M20*1.5	12	24	17.5
DN10	12L	SR-L12	UMW-L12	400	M18*1.5	12	22	15.5
	14S	SR-S14	UMW-S14	500	M22*1.5	14	27	20.5
DN15	15L	SR-L15	UMW-L15	400	M22*1.5	15	27	17
	18L	SR-L18	UMW-L18			18	32	18
	16S	SR-S16	UMW-S16	400	M24*1.5	16	30	20.5
	20S	SR-S20	UMW-S20			20	36	24
	22L	SR-L22	UMW-L22	350	M30*2	22	36	20
DN20	28L	SR-L28	UMW-L28	350	M36*2	28	41	21
	25S	SR-S25	UMW-S25	350		25	46	27
DN25	35L	SR-L35	UMW-L35	350	M45*2	35	50	24
	30S	SR-S30	UMW-S30	350	M42*2	30	50	29
DN32	42L	SR-L42	UMW-L42	350	M52*2	42	60	24
	38S	SR-S38	UMW-S38	350		38	60	32.5

The above selection criteria, the special requirements call.

Parts list

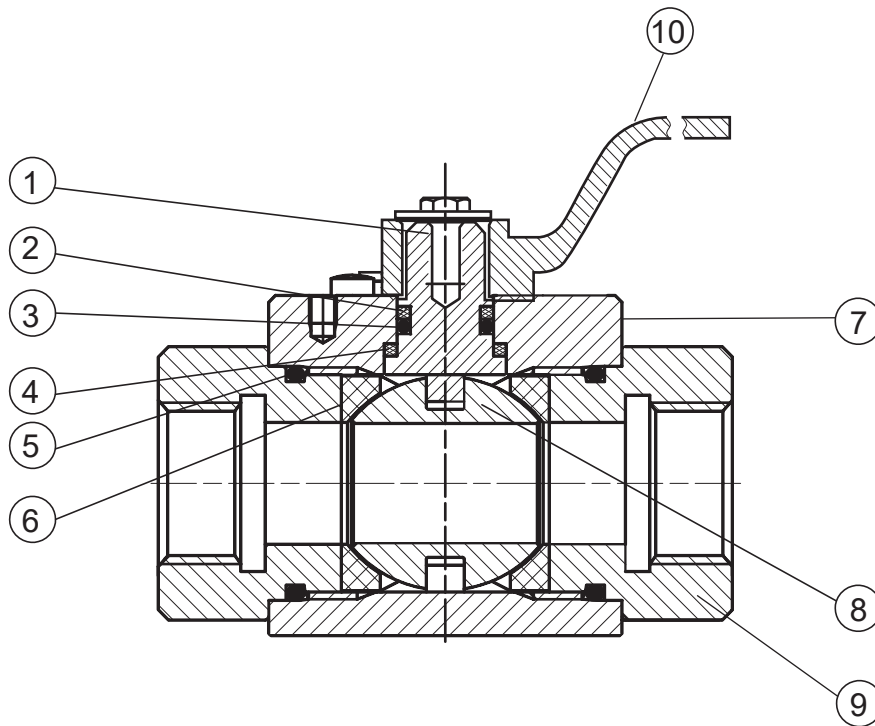

NO.	Description	Material		
1	Shaft	A105	304SS	316SS
2	Washer for o-ring protection	PTFE		
3	O-ring	Viton		
4	Washer	POM+MOS2		
5	O-ring	Viton		
6	Ball sealing	POM/PEEK		
7	Body	304SS		
8	Ball	304SS		
9	Treaded end	304SS		
10	Lever	304SS		

Dimension

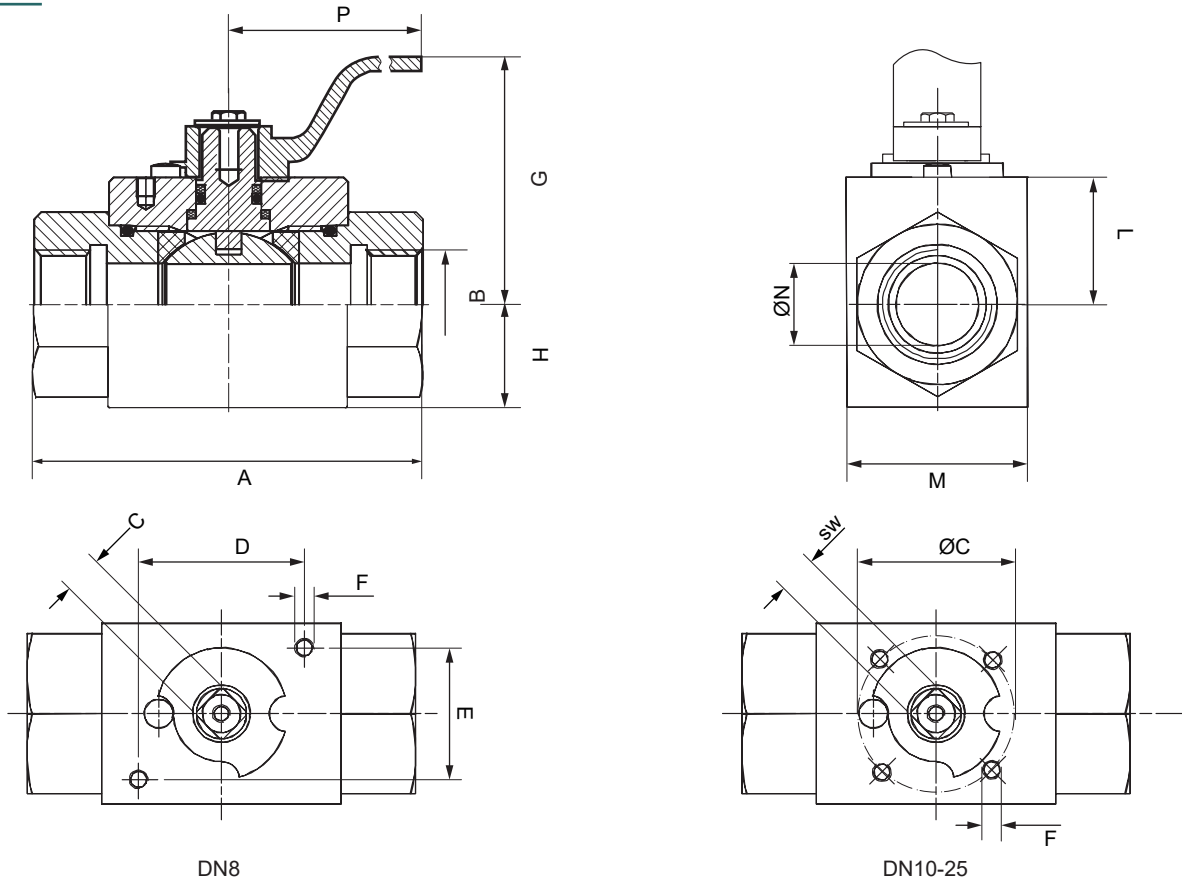

Unit:mm

SIZE	A	B	SW	D	E	F		G	H		L	M		ØN	P	ØC	
						A105	304SS		A105	304SS		A105	304SS			A105	304SS
1/8"	69	1/8"	9	29	19	M5		55.5	13		19	26		6	107	-	
1/4"	69	1/4"	9	29	19	M5		55.5	13		19	26		8	107	-	
3/8"	73	3/8"	9	-	-	M6		58	16.5		21.5	32		10	107	36	
1/2"	85	1/2"	9	-	-	M6		59	17.5		22.5	35		13	107	36	
3/4"	96	3/4"	14	-	-	M8		78	24.5		32.5	49		20	160	50	
1"	113	1"	14	-	-	M8		79.5	27.5		33.5	55		25	210	50	
1 1/4"	110	1 1/4"	17	-	-	M8		102	39.7	39.5	46.8	87	79	32	210	50	
1 1/2"	120	1 1/2"	17	-	-	M8		105	44.2	43	50	95	86	40	210	50	
2"	140	2"	17	-	-	M8	M6	113	52.5	54	57.5	110	108	50	210	50	70

Note:

The data part of the data in the table, the size of stainless steel body and the body is different.

Dimension

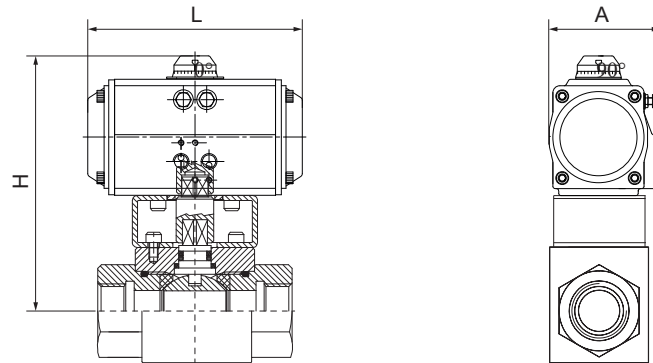

Double acting pneumatic actuator

Unit:mm

Size	Double acting(POM)			Double acting(PEEK)				
	Actuator	L	A	H	Actuator	L	A	H
DN6	DA52	147	72	158	DA63	172	83	174
DN8	DA52	147	72	158	DA63	172	83	174
DN10	DA52	147	72	167	DA63	172	83	183
DN15	DA63	172	83	180	DA75	184	95	192
DN20	DA63	172	83	197	DA75	184	95	209
DN25	DA75	184	95	213	DA83	204	103	222
DN32	DA83	204	103	255	DA92	262	109	263
DN40	DA92	262	109	268	DA105	268	121	284
DN50	DA105	268	268	296	DA125	301	143	318

spring return pneumatic actuator

Unit:mm

Size	Single acting(POM)			Single acting(PEEK)				
	Actuator	L	A	H	Actuator	L	A	H
DN6	SR52	147	72	158	SR63	172	83	174
DN8	SR52	147	72	158	SR63	172	83	174
DN10	SR63	172	83	183	SR75	184	95	195
DN15	SR75	184	95	197	SR83	204	103	206
DN20	SR83	204	103	223	SR92	262	109	231
DN25	SR83	204	103	227	SR92	262	106	235
DN32	SR92	262	109	268.5	SR105	268	121	284.5
DN40	SR105	268	121	292.2	SR125	301	143	314.2
DN50	SR125	301	143	330	SR140	394	152	348

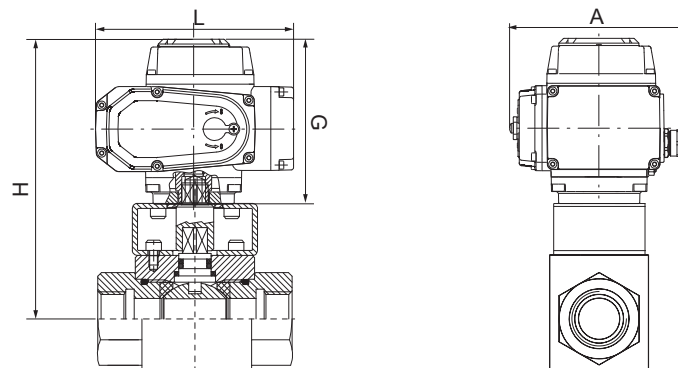

Electric actuator

Unit:mm

Size	Actuator	Non-hazardous			Explosion-proof		
		L	A	H	L	A	H
DN6	HB50	165	140.5	206.5	171	120.5	201.5
DN8	HB50	165	140.5	206.5	171	120.5	201.5
DN10	HB50	165	140.5	212.5	171	120.5	207.5
DN15	HB50	165	140.5	214.5	171	120.5	209.5
DN20	HB50	165	140.5	231.5	171	120.5	226.5
DN25	HB50	165	140.5	235.5	171	120.5	230.5
DN32	HB100	211.5	154	300	218	139	289.5
DN40	HB100	211.5	154	307.7	218	139	297.2
DN50	HB100	211.5	154	325	218	139	314.5

Dimension

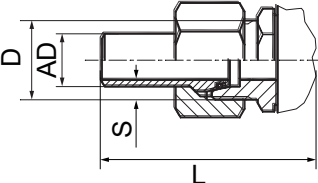
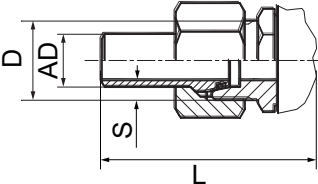
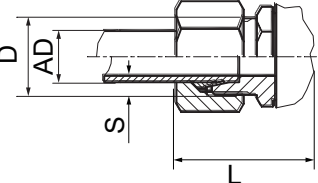
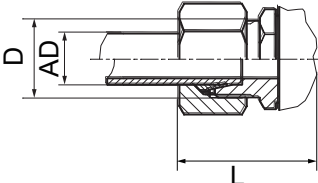
Form of ball valves at both ends of the interface	Commonly used models (Tee seal POM)	Working pressure bar	Path DN	The actual internal diameter LW	D	AD mm	Valve total length L
Welding type DIN2353 Light Series "L" 	A400AL44MMMB10-08L	400	6	6	M14x1.5	8	116
	A400AL44MMMB11-10L	400	8	8	M16x1.5	10	122
	A400AL44MMMB12-12L	400	10	10	M18x1.5	12	126
	A400AL44MMMB13-15L	400	15	13	M22x1.5	15	144
	A400AL44MMMB13-18L	400	15	13	M26x1.5	18	148
	A400AL44MMGB13-22L	350	15	16	M30x2	22	153
	A400AL44MMGB14-28L	350	20	20	M36x2	28	178
	A400AL44MMGB15-35L	350	25	25	M45x2	35	190
	A400AL44MMGB16-42L	350	32	32	M52x2	42	205
	A400AL44MMGB17-48L	350	40	40	M58x2	48	226
Welding type DIN2353 Heavy Series "S" 	A400AL44MMHB10-10S	500	6	6	M18x1.5	10	125
	A400AL44MMHB11-12S	500	8	8	M20x1.5	12	128
	A400AL44MMHB12-14S	500	10	10	M22x1.5	14	147
	A400AL44MMHB13-16S	400	15	13	M24x1.5	16	150
	A400AL44MMHB13-20S	400	15	16	M30x2	20	162
	A400AL44MMHB14-25S	350	20	20	M36x2	25	190
	A400AL44MMMB15-30S	350	25	25	M42x2	30	206
	A400AL44MMMB16-38S	350	32	32	M52x2	38	233
	A400AL44MMMB17-50S	350	40	40	M68x2	50	262
	A400AL44MMGB18-60S	350	50	50	M76x2	60	276
Tube type DIN2353 Light Series "L" 	A400AL44MMMK10-08L	400	6	6	M14x1.5	8	83
	A400AL44MMMK11-10L	400	8	8	M16x1.5	10	86
	A400AL44MMMK12-12L	400	10	10	M18x1.5	12	91
	A400AL44MMMK13-15L	400	15	13	M22x1.5	15	102
	A400AL44MMMK13-18L	400	15	13	M26x1.5	18	106
	A400AL44MMGK13-22L	350	15	16	M30x2	22	110
	A400AL44MMGK14-28L	350	20	20	M36x2	28	128
	A400AL44MMGK15-35L	350	25	25	M45x2	35	140
Tube type DIN2353 Heavy Series "S" 	A400AL44MMHK10-10S	500	6	6	M18x1.5	10	91
	A400AL44MMHK11-12S	500	8	8	M20x1.5	12	94
	A400AL44MMHK12-14S	500	10	10	M22x1.5	14	104
	A400AL44MMHK13-16S	400	15	13	M24x1.5	16	109
	A400AL44MMHK13-20S	400	15	13	M30x2	20	113
	A400AL44MMHK14-25S	350	20	20	M36x2	25	138
	A400AL44MMMK15-30S	350	25	25	M42x2	30	150
	A400AL44MMMK16-38S	350	32	32	M52x2	38	170